

Orona 3G

X-24

## Machine-room above electrical gearless solutions

Latest direct drive technology for existing buildings.

The perfect choice for replacing a lift with machine-room with the minimum of building alterations.

### General specifications

Load	180 to 630 kg
Capacity	2 to 8 persons
Speed	1 m/s
Maximum travel	40 m
Maximum floors served	16 floors
Entrances	1 front / 2 open through / 2 front & side
Drive system	Regulated gearless
Controller	ARCA III controller, low energy consumption multiprocessor
Door types	Automatic side-opening / Automatic central-opening / Semiautomatic + Articulated (BUS)
Clear door opening	From 500 to 900 mm
Door height	2,000 / 2,100 / 2,200 mm
Car dimensions	Parametric car dimensions
Internal car height	2,100 / 2,200 / 2,300 mm
Supply	Three-phase
Aesthetic solutions	Orona 3G Domo Packs / Orona 3G Public Packs / Orona 3G Plus

Standard Optional

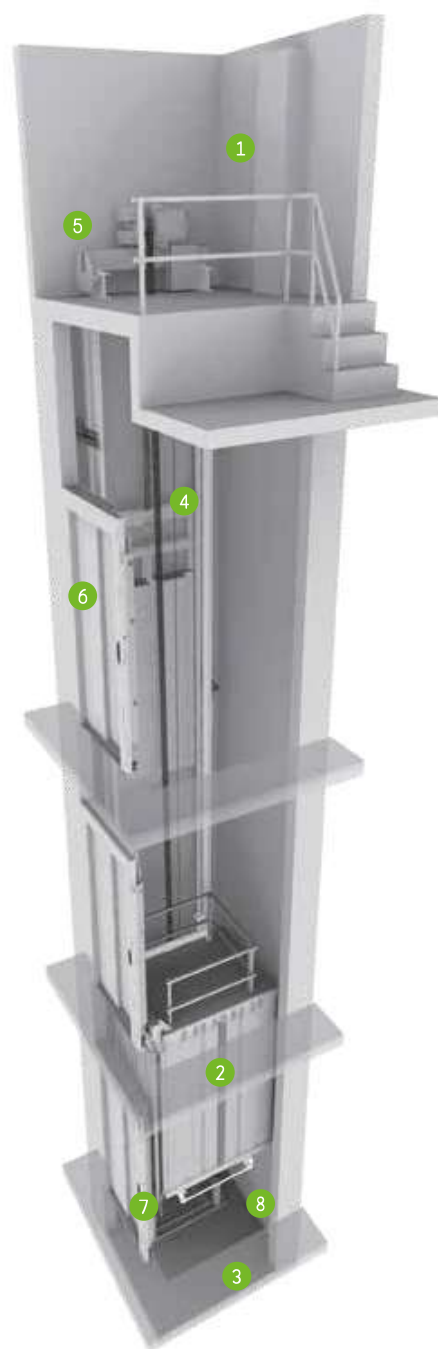

#### 1 MACHINE-ROOM

A traditional solution simplifying lift maintenance.



#### 2 OPTIMISED PASSENGER UNIT

Saves space, reduces weight, improves safety, and improves the installation process.



#### 3 ACCESSIBLE SPACE BELOW THE PIT

Adapts the lift to suit buildings which have an accessible space below the pit (optional).



#### 4 TRACTION ROPES

Orona small diameter ropes replace traditional steel ropes. As a result of their lighter weight, longer lifespan and greater flexibility, it is possible to use a more compact, efficient and eco-friendly gearless machine.



#### 5 DRIVE

Compact, quiet, gearless, energy efficient, speed regulated (VVVF) permanent magnet electric motor.



#### 6 DOORS

Compact permanent magnet motor for fast, accurate and quiet door operation giving the most advanced performance. Advanced door opening and full height infra red door protection edges. Optional Solid Door for high flow situations.



#### 7 AUTOMATIC RESCUE SYSTEM

With floor level indication to ensure fast, efficient and safe evacuation of passengers in the event of an emergency. As an option, the system can incorporate a fully-automatic rescue device to evacuate passengers in the event of a power failure.



#### 8 SHAFT USABILITY

Lifts designed especially to use all the shaft space available especially in existing buildings, obtaining a good relation between the space available and the number of passengers to be transported.



ECO-EFFICIENCY



ADAPTABILITY



DESIGN AND ACCESSIBILITY



CONTROL AND SAFETY

# Standard dimensions\*

Load / capacity		Car			Lift shaft <sup>0</sup>										
					Entrances		Side counterweight		Rear counterweight		HF Pit		HUP Headroom		
					Persons	Q Load	AC Width	FC Depth	PL <sup>5</sup> Clear opening	Accessibility	No. of entrances	Side-opening doors		Central-opening doors	Std.
AH <sup>1</sup> Width	FH <sup>2</sup> Depth	AH <sup>3</sup> Width	FH <sup>2</sup> Depth	With safety space								Without safety space (EN 81-21)			
4	320 kg	825	1,100	700		1	2x180 <sup>0</sup>	1,150	1,300	1,150	1,525	1,000	890	400	3,400
							2x90 <sup>0</sup>	1,250	1,300	1,525					
							1	1,325	1,450	1,300	1,675				
6	450 kg	1,000	1,250	800	♿	1	2x180 <sup>0</sup>	1,425	1,450	1,400	1,675				
							2x90 <sup>0</sup>	1,425	1,450	1,400	1,675				
							1	1,425	1,600	1,450	1,825				
8	630 kg	1,100	1,400	900	♿	1	2x180 <sup>0</sup>	1,525	1,600	1,500	1,825				
							2x90 <sup>0</sup>	1,525	1,600	1,450	1,675				
		1,200	1,250	900	♿	1	2x180 <sup>0</sup>	1,625	1,450	1,500	1,675				

0 Minimum plumb measurements.

1 Accessible space below the pit (counterweight with safety gear) or reduced pit without safety space add 40 mm to AH  
AH calculated for NN 3 panel telescopic door

2 Shaft depth with door tracks projecting as a whole on the landing

3 Width calculated for 4 panel central door

4 HUP minimum for internal car height (HC) 2,100 mm

5 Door restrictions may exist for pits without safety space EN 81-21

\* The information is not contractually binding and is subject to the conditions of the shaft.

## Layout

1 ENTRANCE

2 ENTRANCES (OPEN THROUGH)

2 ENTRANCES (FRONT & SIDE)

VERTICAL SECTION

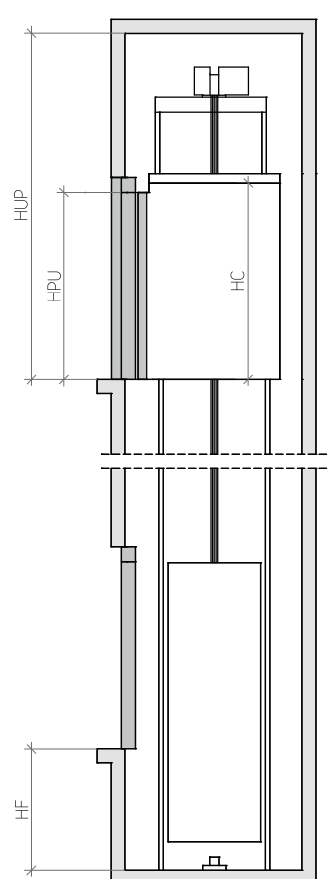
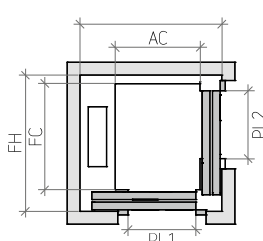
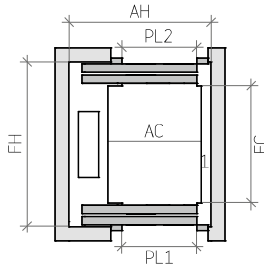
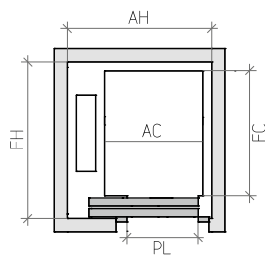

## Customised car dimensions

		Car width														Clear door opening					
		1,450	1,400	1,350	1,300	1,250	1,200	1,150	1,100	1,050	1,000	950	900	850	800	750	500	600	700	800	900
						8	8	8	7	7	6	6	5								
				8	8	8	8	7	7	6	6	6	5								
			8	8	8	7	7	7	6	6	6	5	5								
			8	8	8	7	7	7	6	6	5	5	5	4							
	8	8	8	7	7	7	6	6	5	5	5	5	4	4							
	8	8	7	7	7	6	6	5	5	5	5	4	4	4	3						
	8	7	7	6	6	6	5	5	5	5	4	4	4	4	3						
	7	7	6	6	5	5	5	5	4	4	4	4	3	3							
	6	6	6	5	5	5	5	4	4	4	4	3	3	3							
	6	6	5	5	5	5	4	4	4	4	3	3	3	3							
	5	5	5	5	5	4	4	4	4	3	3	3	3	3							
	5	5	5	4	4	4	4	4	3	3	3	3	3	2							
	5	5	4	4	4	4	4	3	3	3	3	3	2	2							
	4	4	4	4	3	3	3	3	3	3	2	2	2	2							
	4	4	4	3	3	3	3	3	3	3	2	2	2	2							
	4	4	4	3	3	3	3	3	3	2	2	2	2	2							

Note: Car width and depth variable in increments of 5 mm. For simplification, table samples show increments of 50 mm.