

Orona 3G

X-28

Machine-room above electrical gearless solutions

With the latest direct drive technology in public buildings. Less noise and more accessible maintenance. The large-scale customised solution with a machine room, with enhanced performance and maintenance efficiency.

General specifications

Load	1,650 to 2,500 kg
Capacity	22 to 33 persons
Speed	0.6 - 1 - 1.6 m/s
Maximum travel	40 m
Maximum floors served	16 floors
Entrances	1 front / 2 open through
Drive system	Regulated gearless
Controller	ARCA III controller, low energy consumption multiprocessor
Door types	Automatic side-opening / Automatic central-opening
Clear door opening	From 900 to 2,500 mm (in increments of 100 mm)
Door height	2,000 / 2,100 / 2,200 / 2,300 mm
Car dimensions	Parametric car dimensions
Internal car height	2,100 / 2,200 / 2,300 / 2,400 mm
Aesthetic solutions	Orona 3G Plus

Standard Optional



1 DRIVE

Compact, quiet, gearless, energy efficient, speed regulated (VVVF) permanent magnet electric motor.



2 AUTOMATIC RESCUE SYSTEM

With floor level indication to ensure fast, efficient and safe evacuation of passengers in the event of an emergency. As an option, the system can incorporate a fully-automatic rescue device to evacuate passengers in the event of a power failure.



3 SOLID DOORS

Extra robust doors with reduced sound levels inside and outside the lift and which are specially constructed for high volume passenger traffic.



4 MACHINE-ROOM

A traditional solution simplifying lift maintenance.



5 PARAMETRIC/FLEXIBLE

Flexible car and door configurations ensure available shaft dimensions can be optimised (optional).



6 ROBUST LIFT CAR

Provides greater comfort during lift travel, with reduced vibration and noise.



7 CARS

Reinforced wall panels and flooring provides durability for heavy duty usage. Flexible configurations offering optimum car and door dimensions.



8 ACCESSIBLE SPACE BELOW THE PIT

Adapts the lift to suit buildings which have an accessible space below the pit (optional).



Standard dimensions*

Load / capacity				Car				Lift shaft ⁰				
Speed	Accessibility	Persons	Q Load	AC Width	FC Depth	PL Clear opening	Type	No. of entrances	AH ¹ Width	FH Depth	HF ² Pit	HUP ³ Headroom
0.6 m/s	[Accessibility Icon]	24	1,800 kg	2,350	1,600	1,200	CC	1	3,150	1,950	1,450	3,400
				2,350	1,700	1,200		2x180 ⁰		2,160		
		2,600	1,700	1,200	CC	1	2,050					
	26	2,000 kg	2,350	1,700	1,200	CC	1	3,150	2,260			
			1,500	2,700	1,300		TT		2x180 ⁰	3,050		
		2,500 kg	1,800	2,700	1,300	TT	2x180 ⁰	3,260				
1 m/s	[Accessibility Icon]	24	1,800 kg	2,350	1,600	1,200	CC	1	3,150	1,950	1,450	3,425
				2,350	1,700	1,200		CC		1		
		2,600	1,700	1,200	CC	1	2,260					
	26	2,000 kg	2,350	1,700	1,200	CC	1	3,150	3,050			
			1,500	2,700	1,300		TT		2x180 ⁰	3,260		
		2,500 kg	1,800	2,700	1,300	TT	2x180 ⁰	3,260				
1.6 m/s	[Accessibility Icon]	24	1,800 kg	2,350	1,600	1,200	CC	1	3,150	2,050	1,600	3,565
				2,350	1,700	1,200		CC		1		
		2,600	1,700	1,200	CC	1	2,050					
	26	2,000 kg	2,350	1,700	1,200	CC	1	3,150	2,260			
			1,500	2,700	1,300		TT		2x180 ⁰	3,050		
		2,500 kg	1,800	2,700	1,300	TT	2x180 ⁰	3,260				

⁰ Minimum plumb measurements

¹ With TT doors

² With PVC flooring. Marble floor option + 20 mm

³ HUP minimum for internal car height (HC) 2,100 mm.

CC - Two panel central door

TT - Two panel telescopic door

* The information is not contractually binding and is subject to the conditions of the shaft

Layout

1 ENTRANCE

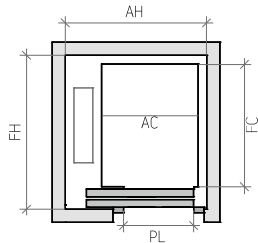

2 ENTRANCES (OPEN THROUGH)

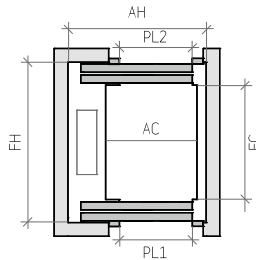

VERTICAL SECTION

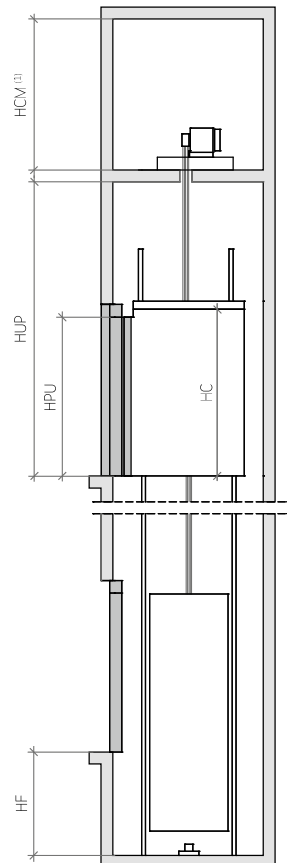

Customised car dimensions

Car depth		Car width																					
		33	31	30	29	28	27	26	25	24	23	22	21	20	19	18	17	16	15	14			
3,000	2,900																				33	2,900	
																					33	2,800	
																					33	2,700	
																					33	2,600	
																					33	2,500	
																					33	2,400	
																					33	2,300	
																					33	2,200	
																					33	2,100	
																					33	2,000	
																					33	1,900	
																					33	1,800	
																					33	1,700	
																					33	1,600	
																					33	1,500	
																					33	1,400	
3,000	2,900	2,800	2,700	2,600	2,500	2,400	2,300	2,200	2,100	2,000	1,900	1,800	1,700									900	
																							1,000
																							1,100
																							1,200
																							1,300
																							1,400
																							1,500
																							1,600
																							1,700
																							1,800
																							1,900
																							2,000
																							2,100
																							2,200
																							2,300
																							2,400
																							2,500

Note: Car width and depth variable in increments of 5 mm.

For simplification, table samples show increments of 100 mm.

(1) HCM - minimum 2000 mm